

FUSION-GRILL



Fusion-Grill, a compact luminaire with a microprismatic lens, developed for placement in grid ceilings. This luminaire is available in different sizes (width and length) with a matte finish to properly adapt to the different types of grill ceilings on the market.

- Compact luminaire for grid ceiling systems
- Custom light fixture available with sizes on request
- Microprismatic lens (UGR <19)
- Matte black or matte white textured powder coating

Downloads

[Photometrics Fusion Grill](#)

Create your own custom made product, download the PDF specsheet or add to quote:

PRODUCT IMAGES

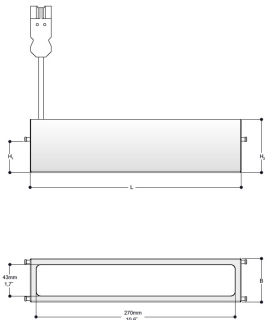
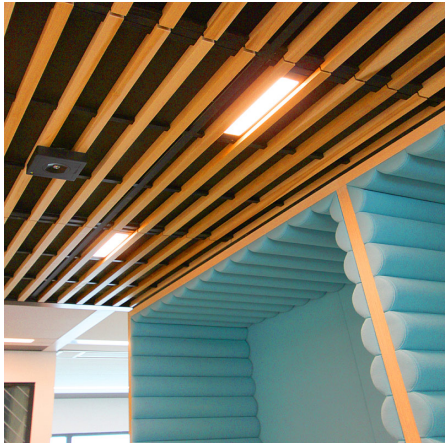

f-waardering volgens UGR												
p Plafond	70	70	50	50	30	70	70	50	50	30		
p Muren	50	30	50	30	30	50	30	50	30	30		
p Voer	20	20	20	20	20	20	20	20	20	20		
Ruimteafmeting		Perspectief dwars					Perspectief langs					
X	Y	s.o.v. lampen					s.o.v. lampen					
2H	2H	17.4	18.4	17.7	18.6	18.8	17.4	18.3	17.7	18.6	18.8	
	3H	17.8	18.6	18.1	18.9	19.1	17.7	18.6	18.0	18.8	19.1	
	4H	17.9	18.7	18.3	19.0	19.3	17.9	18.7	18.3	19.0	19.3	
	6H	18.1	18.8	18.4	19.1	19.4	18.0	18.8	18.4	19.1	19.4	
	12H	18.1	18.8	18.5	19.1	19.4	18.1	18.7	18.4	19.1	19.4	
4H	2H	17.5	18.3	17.8	18.5	18.8	17.4	18.2	17.8	18.5	18.8	
	3H	17.9	18.6	18.3	18.9	19.3	17.9	18.6	18.3	18.9	19.2	
	4H	18.2	18.8	18.6	19.2	19.5	18.2	18.8	18.6	19.1	19.5	
	6H	18.4	18.9	18.8	19.3	19.7	18.4	18.9	18.8	19.3	19.7	
	12H	18.5	18.9	18.9	19.3	19.7	18.5	18.9	18.9	19.3	19.7	
8H	2H	18.3	18.7	18.7	19.1	19.5	18.3	18.7	18.7	19.1	19.5	
	3H	18.5	18.9	19.0	19.3	19.8	18.5	18.9	19.0	19.3	19.8	
	4H	18.6	18.9	19.1	19.4	19.9	18.6	18.9	19.1	19.3	19.8	
	6H	18.7	19.0	19.2	19.4	20.0	18.7	18.9	19.2	19.4	19.9	
	12H	18.7	19.0	19.2	19.4	20.0	18.7	18.9	19.2	19.4	19.9	
12H	2H	18.3	18.7	18.7	19.1	19.5	18.3	18.7	18.7	19.1	19.5	
	3H	18.5	18.9	19.0	19.3	19.8	18.5	18.9	19.0	19.3	19.8	
	4H	18.6	18.9	19.1	19.4	19.9	18.6	18.9	19.1	19.3	19.8	
	6H	18.7	19.0	19.2	19.4	20.0	18.7	18.9	19.2	19.4	19.9	
	12H	18.7	19.0	19.2	19.4	20.0	18.7	18.9	19.2	19.4	19.9	
Variatie op assemerenposities voor lampakslenden S												
S = 1.0H		+1.2 / -1.7					+1.1 / -1.6					
S = 1.5H		+2.3 / -2.1					+2.4 / -1.9					
S = 2.0H		+3.8 / -2.8					+3.9 / -2.9					
Standartaafmeting		BK02					BK02					
Correctie-optelal		0.6					0.6					
Geconigeerde verblindingindicatie in relatie tot 3790lm Totale lichtstroom												

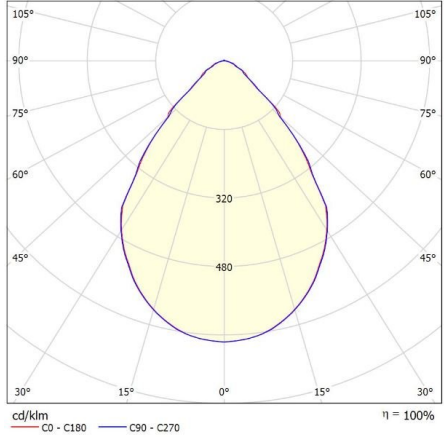

NOTES

ADDITIONAL INFORMATION

Appliance class	Class-II
Application	Education, Exposure, Hospitality, Municipality, Office, Retail
C-hook height	30-45mm
CIE Flux Code	76 94 99 99 100
Colour Rendering Index (CRI)	CRI80, CRI90
Colour consistency (SDCM)	SDCM = 3
Colour temperature	Tunable white, 3000K, 4000K
Designed	Philip Feenstra, 2015
Driver position	Separate driving position
Emergency lighting	Optional
Energy label	A++
Expected lifetime	L90B50@60.000h (Tq 25 ° C)
Glare (UGR)	<19
Gross weight	1.6 kg
Height	80mm
IP-class	IP20 (top) / IP40 (bottom)
Length	290mm
Lighting control	Optional
Luminaire efficacy	>125lm/W
Material	Steel, Acrylate
Mounting depth	80mm
Number of modules	1
Operational temperature	-20 ° C / + 40 ° C
Optic	Microprismatic lens
Orientation	Down
Packaging dimensions	400x400x300mm
Power factor	>0.9
Primary connection	GST18i3, GST18i5 pastel blue, On the driver
Shape	Rectangular
Voltage / frequency	220-240V, 50 / 60Hz

Way of mounting	Recessed
Width	40mm, 50mm, 60mm
Fusion-Grill	12W 1300lm 3000K CRI80, 12W 1300lm 4000K CRI80, 4W 500lm 4000K CRI80, 4W 550lm 3000K CRI80, 8W 900lm 3000K CRI80, 8W 900lm 4000K CRI80, Version to be determined
Product colour	Matt white, Matte Black
Photobiological safety	IEC 62471: RG1 (low risk)
Air extraction	Outside the luminaire
Shortened on site	No

