

## SIRIO SAPP 900

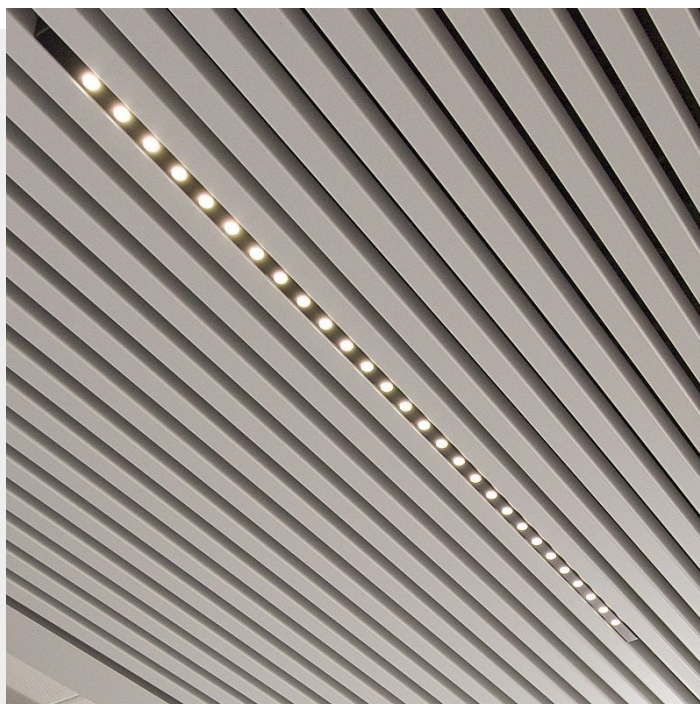

A linear lighting fixture with lenses for use in Interlu SAPP® ceiling ceiling. Sirio SAPP 900 can be placed between the structures and thus creates an integrated system with the ceiling, without interrupting the architectural appearance.

- Can be placed anywhere in the ceiling between the SAPP® ceiling structures without interrupting the climate circuit
- Provides a highly controlled light distribution, good uniformity and UGR <19
- The luminaire complies with NEN-EN 12464-1

### **Downloads**

[Photometrics Sirio SAPP](#)

**Create your own custom made product, download the PDF specsheet or add to quote:**

PRODUCT IMAGES

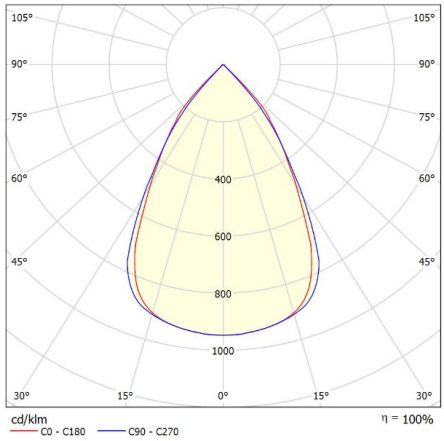
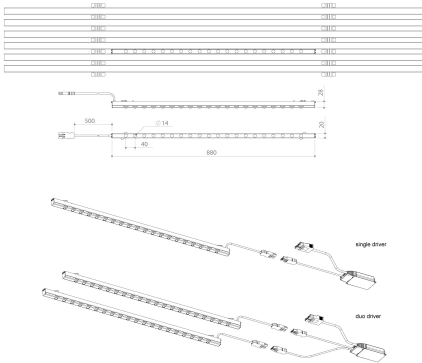
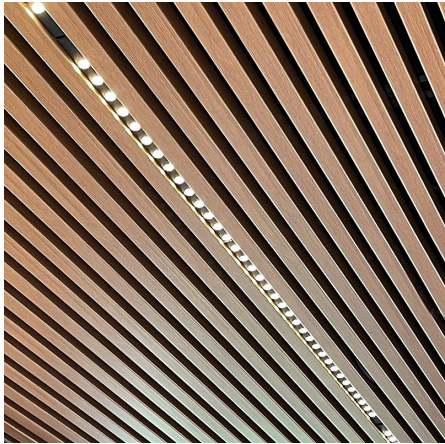

Glare Evaluation According to UGR													
p Ceiling		70	70	50	50	30	70	70	50	50	30		
p Walls		50	30	50	30	30	50	30	50	30	30		
p Floor		20	20	20	20	20	20	20	20	20	20		
Room Size X Y		Viewing direction at right angles to lamp axis						Viewing direction parallel to lamp axis					
2H	2H	18.7	19.4	18.9	19.6	19.8	18.3	19.0	18.5	19.2	19.4		
	3H	18.6	19.2	18.8	19.4	19.7	18.1	18.8	18.4	19.0	19.2		
	4H	18.5	19.1	18.8	19.3	19.6	18.1	18.7	18.4	18.9	19.2		
	6H	18.4	19.0	18.7	19.2	19.5	18.0	18.5	18.3	18.6	19.1		
	12H	18.3	18.8	18.7	19.1	19.5	17.9	18.4	18.3	18.7	19.0		
4H	2H	18.5	19.1	18.8	19.3	19.6	18.1	18.7	18.4	18.9	19.2		
	3H	18.3	18.8	18.7	19.1	19.5	17.9	18.4	18.3	18.7	19.0		
	4H	18.3	18.7	18.6	19.0	19.4	17.9	18.3	18.2	18.6	19.0		
	6H	18.2	18.6	18.6	18.9	19.3	17.8	18.1	18.2	18.5	18.9		
	12H	18.1	18.5	18.6	18.9	19.3	17.8	18.1	18.2	18.5	18.9		
8H	2H	18.1	18.4	18.6	18.8	19.2	17.7	18.0	18.2	18.4	18.8		
	3H	18.2	18.5	18.6	18.9	19.3	17.7	18.1	18.2	18.4	18.8		
	4H	18.1	18.3	18.5	18.7	19.2	17.7	17.9	18.1	18.3	18.8		
	6H	18.0	18.2	18.5	18.7	19.2	17.6	17.8	18.1	18.3	18.7		
	12H	18.0	18.2	18.5	18.6	19.1	17.6	17.7	18.1	18.2	18.7		
12H	2H	18.1	18.4	18.6	18.8	19.2	17.7	18.0	18.1	18.4	18.8		
	3H	18.0	18.2	18.5	18.7	19.2	17.6	17.8	18.1	18.3	18.7		
	4H	18.0	18.2	18.5	18.6	19.1	17.6	17.7	18.1	18.2	18.7		
	6H	18.0	18.2	18.5	18.6	19.1	17.6	17.7	18.1	18.3	18.7		
	12H	18.0	18.2	18.5	18.6	19.1	17.6	17.7	18.1	18.2	18.7		
Variation of the observer position for the luminaire distances S													
S = 1.0H		+3.8 / -12.2						+4.7 / -13.4					
S = 1.5H		+6.5 / -14.3						+7.5 / -14.8					
S = 2.0H		+8.5 / -15.6						+9.5 / -15.5					
Standard table		BK00						BK00					
Correction Summand		0.0						-0.4					
Corrected Glare Indices referring to 3283lm Total Luminous Flux													

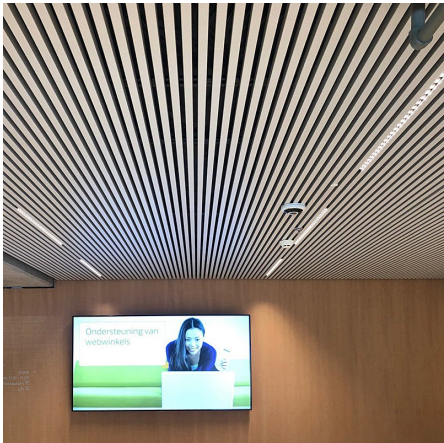
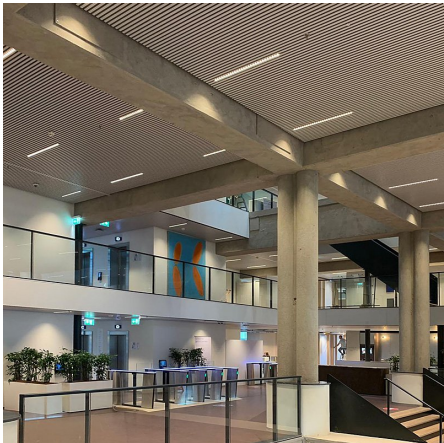
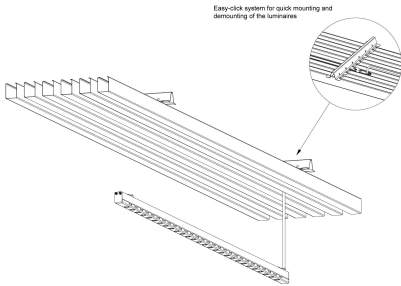

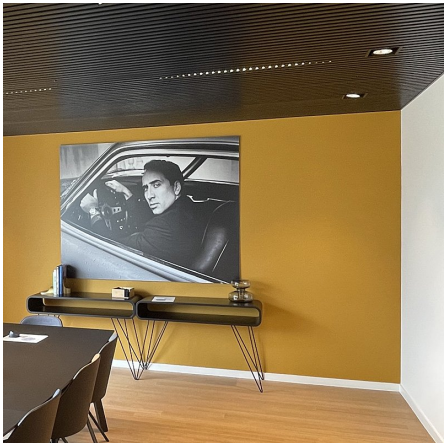
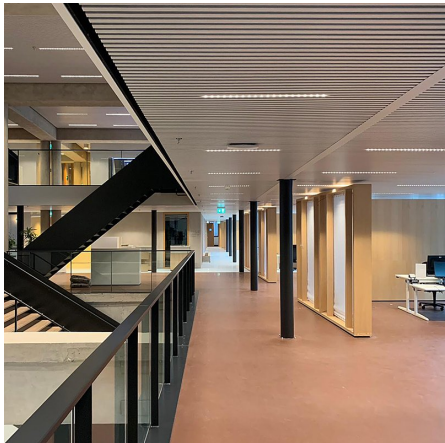

NOTES

---

---

---

---

---

---



## ADDITIONAL INFORMATION

<b>Application</b>	Education, Hospitality, Municipality, Office, Retail
<b>Way of mounting</b>	Recessed
<b>Operational temperature</b>	-20 ° C / + 40 ° C
<b>Optic</b>	Lens
<b>Orientation</b>	Down
<b>Designed</b>	Philip Feenstra, 2019
<b>Material</b>	Steel, Acrylate
<b>IP-class</b>	IP20 (top) / IP40 (bottom)
<b>Length</b>	880mm
<b>Width</b>	21.5mm
<b>Mounting depth</b>	40mm
<b>Gross weight</b>	1.1KG (ex driver) 0.4KG (driver)
<b>Packaging dimensions</b>	Bulk packaging
<b>Colour temperature</b>	3000K, 4000K
<b>Colour Rendering Index (CRI)</b>	CRI80, CRI90
<b>Glare (UGR)</b>	<19
<b>CIE Flux Code</b>	94 100 100 100 100
<b>Luminaire efficacy</b>	129lm/W - 143lm/W
<b>Expected lifetime</b>	L90B50@60.000h (Tq 25 ° C)
<b>Voltage / frequency</b>	220-240V, 50 / 60Hz
<b>Power factor</b>	>0.9
<b>Appliance class</b>	Class-II
<b>Driver position</b>	Separate driving position
<b>Number of modules</b>	20
<b>Lighting control</b>	Optional
<b>Emergency lighting</b>	Optional
<b>Product colour</b>	RAL9011 matt structure
<b>Colour consistancy (SDCM)</b>	SDCM = 3
<b>Air extraction</b>	N/A
<b>Energy label</b>	A++

## Photobiological safety

IEC 62471: RG1 (low risk)

## Sirio

Version to be determined, 900 10W 1300lm 4000K CRI80 G7d, 900 11W 1500lm 4000K CRI80 G8 low-glare, 900 12W 1500lm 4000K CRI80 G7d, 900 12W 1700lm 4000K CRI80 G8 low-glare, 900 7W 900lm 3000K CRI80 G7d, 900 13W 1700lm 4000K CRI80 G7d, 900 16W 2100 4000K CRI80 G7d, 900 9W 1100lm 3000K CRI80 G7d, 900 16W 2000lm 4000K CRI80 G7d, 900 10W 1300lm 3000K CRI80 G7d, 900 18W 2200lm 4000K CRI80 G7d, 900 12W 1400lm 3000K CRI80 G7d, 900 7W 1000lm 3000K CRI80 G8 low-glare, 900 13W 1600lm 3000K CRI80 G7d, 900 9W 1200lm 3000K CRI80 G8 low-glare, 900 16W 1900lm 3000K CRI80 G7d, 900 11W 1400lm 3000K CRI80 G8 low-glare, 900 18W 2100lm 3000K CRI80 G7d, 900 12W 1600lm 3000K CRI80 G8 low-glare, 900 7W 900lm 4000K CRI80 G7d, 900 7W 1100lm 4000K CRI80 G8 low-glare, 900 9W 1100lm 4000K CRI80 G7d, 900 9W 1300lm 4000K CRI80 G8 low-glare

## Specification

G7D1 / 06-02-2025

