



## **FUSION-GRILL**

Fusion-Grill, a compact luminaire with a microprismatic lens, developed for installation in suspended ceilings. This luminaire is available in various sizes (width and length) with a matte finish to adapt well to the different types of grill ceilings on the market.

- Compact luminaire for suspended ceilings
- Custom luminaire available with dimensions on request
- Microprismatic lens (UGR < 19)
- Matte black or matte white textured powder coating

### **Downloads**

[Photometrics Fusion Grill](#)

**Categories:** [Baffle luminaires](#)



## PRODUCT IMAGES

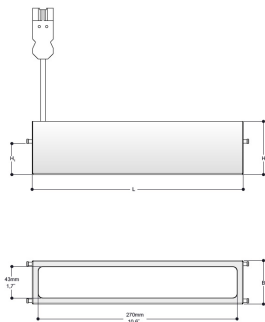

f-waardering volgens UGR												
p. Plafond	70	70	50	50	30	70	70	50	50	30		
p. Muren	50	30	50	30	30	50	30	50	30	30		
p. Voer	20	20	20	20	20	20	20	20	20	20		
Ruimteafmeting	X	Y	Perspectief dwars					Perspectief langs				
			t.o.v. lampen					t.o.v. lampen				
2H	2H	17.4	18.4	17.7	18.6	18.8	17.4	18.3	17.7	18.6	18.8	
	3H	17.8	18.6	18.1	18.9	19.1	17.7	18.6	18.0	18.8	19.1	
	4H	17.9	18.7	18.3	19.0	19.3	17.9	18.7	18.3	19.0	19.3	
	6H	18.1	18.8	18.4	19.1	19.4	18.0	18.8	18.4	19.1	19.4	
	8H	18.1	18.8	18.4	19.1	19.4	18.1	18.7	18.4	19.1	19.4	
4H	2H	17.5	18.3	17.8	18.5	18.8	17.4	18.2	17.8	18.5	18.8	
	3H	17.9	18.6	18.3	18.9	19.3	17.9	18.6	18.3	18.9	19.2	
	4H	18.2	18.8	18.6	19.2	19.5	18.2	18.8	18.6	19.1	19.5	
	6H	18.4	18.9	18.8	19.3	19.7	18.4	18.9	18.8	19.3	19.7	
	8H	18.5	18.9	18.9	19.3	19.7	18.5	18.9	18.9	19.3	19.7	
8H	2H	18.3	18.7	18.7	19.1	19.5	18.3	18.7	18.7	19.1	19.5	
	3H	18.5	18.9	19.0	19.3	19.8	18.5	18.9	19.0	19.3	19.8	
	4H	18.6	18.9	19.1	19.4	19.9	18.6	18.9	19.1	19.3	19.8	
	6H	18.7	19.0	19.2	19.4	20.0	18.7	18.9	19.2	19.4	19.9	
	8H	18.8	19.1	19.3	19.5	20.1	18.8	19.0	19.2	19.4	20.0	
12H	2H	18.3	18.7	18.7	19.1	19.5	18.3	18.7	18.7	19.1	19.5	
	3H	18.5	18.9	19.0	19.3	19.8	18.5	18.9	19.0	19.3	19.8	
	4H	18.6	18.9	19.1	19.4	19.9	18.6	18.9	19.1	19.3	19.8	
	6H	18.7	19.0	19.2	19.4	20.0	18.7	18.9	19.2	19.4	19.9	
	8H	18.8	19.1	19.3	19.5	20.1	18.8	19.0	19.2	19.4	20.0	

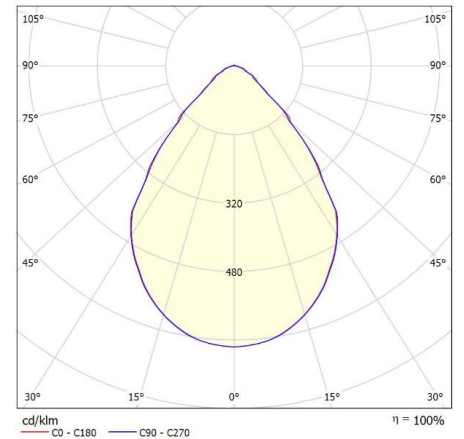

Fusion-Grill, a compact luminaire with a microprismatic lens, developed for installation in suspended ceilings. This luminaire is available in various sizes (width and length) with a matte finish to adapt well to the different types of grill ceilings on the market.

- Compact luminaire for suspended ceilings
- Custom luminaire available with dimensions on request
- Microprismatic lens (UGR< 19)
- Matte black or matte white textured powder coating

## Downloads

[Photometrics Fusion Grill](#)

NOTES

---

---

---

---

---

---

## ADDITIONAL INFORMATION

<b>Insulation Class</b>	Class II
<b>Driver position</b>	Attached to the fixture, Loose driver
<b>Lighting control</b>	1-10V dimming, Casambi dimming, DALI dimming, Optional
<b>Application</b>	Education, Hospitality, Office, Public spaces
<b>Material</b>	Acrylic, Steel
<b>Width</b>	50mm
<b>Photobiological safety</b>	IEC 62471: RG1 (low risc)
<b>Color temperature</b>	Tunable White, 2700K
<b>Kleurconsistentie (SDCM)</b>	SDCM=3
<b>Optics</b>	Microprismatic lens, Opalen diffusor
<b>Ambient temperature</b>	-20°C / +40°C
<b>Primary connections</b>	GST18i3, GST18i5 pastelblauw, Kabel, On the driver
<b>Emergency lighting</b>	1 hour emergency power, Optional, Optional 1 hour autonomy self-test
<b>Product Color</b>	On request, RAL9010 mat, RAL9010 mat structuur, RAL9011 mat, RAL9011 mat structuur, RAL9016 mat, RAL9016 mat structuur
<b>Luminaire efficacy</b>	>133lm/W
<b>Product family</b>	Fusion
<b>Color Rendering Index (CRI)</b>	CRI80, CRI90
<b>Energy Rating</b>	
<b>Expected lifespan</b>	L90B50@60,000h (Tq 25°C)
<b>Oriëntatie</b>	Down
<b>Power factor</b>	>0.9
<b>Shape</b>	Rectangular
<b>Product Confirmation</b>	Recessed

