



MESON PRO 190-C

Meson Pro 190-C is a series of high-quality LED downlights for surface mounting, equipped with a glare-reducing reflector and a satin diffuser. The innovative design of LED array, light chamber, reflector and diffuser forms an optical system with high system efficiency and excellent visual comfort. Meson pro 190-C has a highly effective Light Output Ratio (LOR) more than 84% and an Unified Glare Rating (UGR) between <16 and <19 depending on the luminaire flux which makes the downlighter EN 1.2464/1 compliant for office applications.

- Housing in matte white or matte black
- UGR < 17 to UGR < 19 depending on luminous flux
- Emergency lighting versions available

Downloads

[Photometrics Meson Pro 190-C](#) [Download Meson Pro BIM files](#)

Categories: [Surface-mounted luminaires](#)



PRODUCT IMAGES

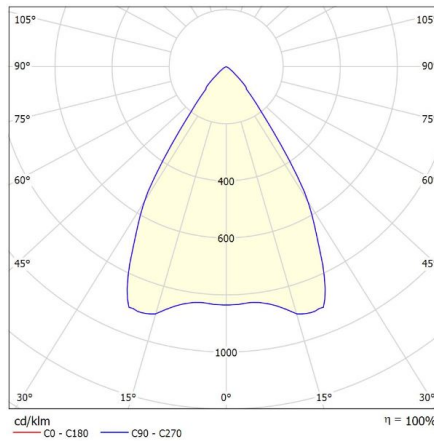
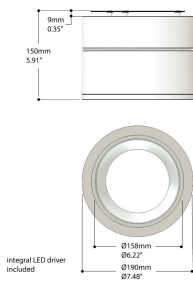

Glare Evaluation According to UGR												
p Ceiling	70	70	50	50	30	70	70	50	50	30		
p Walls	50	30	50	30	30	50	30	50	30	30		
p Floor	20	20	20	20	20	20	20	20	20	20		
Room Size X Y	Viewing direction at right angles to lamp axis					Viewing direction parallel to lamp axis						
2H	2H	19.0	19.7	19.2	19.9	20.1	19.0	19.7	19.2	19.9	20.1	
	3H	18.8	19.5	19.1	19.7	19.9	18.8	19.5	19.1	19.7	19.9	
	4H	18.8	19.4	19.1	19.6	19.9	18.8	19.4	19.1	19.6	19.9	
	6H	18.7	19.2	19.0	19.5	19.8	18.7	19.2	19.0	19.5	19.8	
	12H	18.6	19.2	19.0	19.5	19.8	18.6	19.2	19.0	19.5	19.8	
4H	2H	18.8	19.4	19.1	19.6	19.9	18.8	19.4	19.1	19.6	19.9	
	3H	18.6	19.1	19.0	19.4	19.8	18.6	19.1	19.0	19.4	19.8	
	4H	18.6	19.0	18.9	19.3	19.7	18.6	19.0	18.9	19.3	19.7	
	6H	18.5	18.9	18.9	19.2	19.6	18.5	18.9	18.9	19.2	19.6	
	12H	18.4	18.7	18.8	19.1	19.5	18.4	18.7	18.8	19.1	19.5	
6H	2H	18.5	18.8	18.9	19.2	19.6	18.5	18.8	18.9	19.2	19.6	
	3H	18.4	18.6	18.8	19.0	19.5	18.4	18.6	18.8	19.0	19.5	
	4H	18.3	18.5	18.8	19.0	19.4	18.3	18.5	18.8	19.0	19.4	
	6H	18.3	18.4	18.8	18.9	19.4	18.3	18.4	18.8	18.9	19.4	
	12H	18.3	18.4	18.8	18.9	19.4	18.3	18.4	18.8	18.9	19.4	
Variation of the observer position for the luminance distances S												
S = 1.0H		+5.0 / -8.2						+5.0 / -8.2				
S = 1.5H		+7.7 / -13.2						+7.7 / -13.2				
S = 2.0H		+9.7 / -13.2						+9.7 / -13.2				
Standard table		BK00					BK00					
Correction		0.3					0.3					
Corrected Glare indices referring to 2683lm Total Luminous Flux												

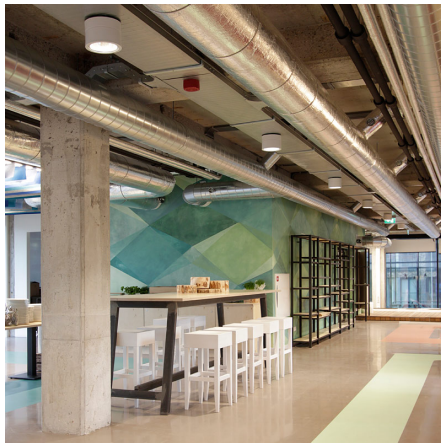

Meson Pro 190-C is a series of high-quality LED downlights for surface mounting, equipped with a glare-reducing reflector and a satin diffuser. The innovative design of LED array, light chamber, reflector and diffuser forms an optical system with high system efficiency and excellent visual comfort. Meson pro 190-C has a highly effective Light Output Ratio (LOR) more than 84% and an Unified Glare Rating (UGR) between <16 and <19 depending on the luminaire flux which makes the downlighter EN 1.2464/1 compliant for office applications.

- Housing in matte white or matte black
- UGR< 17 to UGR< 19 depending on luminous flux

- Emergency lighting versions available

Downloads

[Photometrics Meson Pro 190-C](#) [Download Meson Pro BIM files](#)

NOTES

ADDITIONAL INFORMATION

Color temperature	Tunable White, 2700K
Ambient temperature	-20°C / +40°C
Product Color	Matte black, Matte white, On request
Lighting control	1-10V dimming, Casambi dimming, DALI dimming, Optional
Emergency lighting	1 hour emergency power, Optional, Optional 1 hour autonomy self-test
Application	Education, Hospitality, Office, Public spaces
Primary connections	On the driver
Driver position	Integrated
Insulation Class	Class II
Product family	Meson
Material	Acrylic, Aluminum, Steel
Oriëntatie	Down
Kleurconsistentie (SDCM)	SDCM=2
Color Rendering Index (CRI)	CRI80, CRI90
Expected lifespan	L90B50@60,000h (Tq 25°C)
Power factor	>0.9
Product Confirmation	Ceiling mounting
Shape	Round
Energy Rating	
Photobiological safety	IEC 62471: RG1 (low risc)

