

SIRIO SAPP 1500

A linear lighting fixture with lenses for use in Interlu SAPP® ceilings.

- Sirio SAPP 1500 can be placed between structures, creating an integrated system with the ceiling without disrupting the architectural appearance.
- Provides highly controlled light distribution, excellent uniformity and UGR<19
- The fixture complies with NEN-EN 12464-1

Downloads

[Photometrics Sirio SAPP](#)

Create your own product, download the PDF specification sheet or add to the quotation:

Categories: [Climate ceiling fixtures](#), [Baffle luminaires](#)



PRODUCT IMAGES

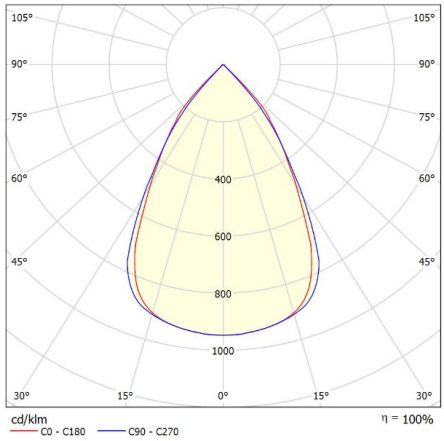
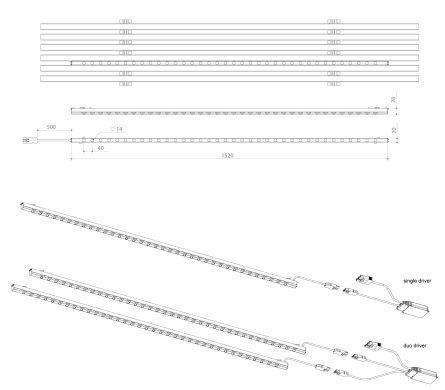
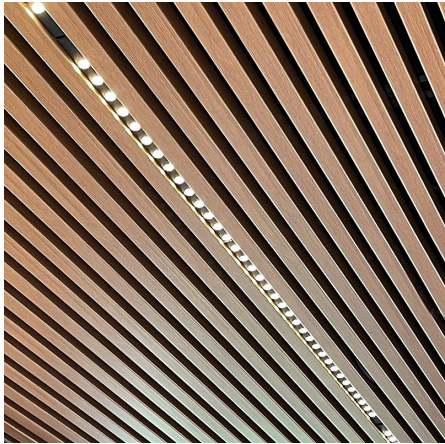

Glare Evaluation According to UGR												
p Ceiling		70	70	50	50	30	70	70	50	50	30	
p Walls		50	30	50	30	30	50	30	50	30	30	
p Floor		20	20	20	20	20	20	20	20	20	20	
Room Size X Y		Viewing direction at right angles to lamp axis					Viewing direction parallel to lamp axis					
2H	2H	18.7	19.4	18.9	19.6	19.8	18.3	19.0	18.5	19.2	19.4	
	3H	18.6	19.2	18.8	19.4	19.7	18.1	18.8	18.4	19.0	19.2	
	4H	18.5	19.1	18.8	19.3	19.6	18.1	18.7	18.4	18.9	19.2	
	6H	18.4	19.0	18.7	19.2	19.5	18.0	18.5	18.3	18.6	19.1	
	12H	18.3	18.8	18.7	19.1	19.5	17.9	18.4	18.3	18.7	19.0	
4H	2H	18.5	19.1	18.8	19.3	19.6	18.1	18.7	18.4	18.9	19.2	
	3H	18.3	18.8	18.7	19.1	19.5	17.9	18.4	18.3	18.7	19.0	
	4H	18.3	18.7	18.6	19.0	19.4	17.9	18.3	18.2	18.6	19.0	
	6H	18.2	18.6	18.6	18.9	19.3	17.8	18.1	18.2	18.5	18.9	
	12H	18.1	18.5	18.6	18.9	19.3	17.8	18.1	18.2	18.5	18.9	
8H	2H	18.1	18.4	18.6	18.8	19.2	17.7	18.0	18.2	18.4	18.8	
	3H	18.2	18.5	18.6	18.9	19.3	17.7	18.1	18.2	18.4	18.8	
	4H	18.1	18.3	18.5	18.7	19.2	17.7	17.9	18.1	18.3	18.8	
	6H	18.0	18.2	18.5	18.7	19.2	17.6	17.8	18.1	18.3	18.7	
	12H	18.0	18.2	18.5	18.6	19.1	17.6	17.7	18.1	18.2	18.7	
12H	2H	18.1	18.4	18.6	18.8	19.2	17.7	18.0	18.1	18.4	18.8	
	3H	18.2	18.5	18.6	18.9	19.3	17.7	18.1	18.2	18.4	18.8	
	4H	18.1	18.3	18.5	18.7	19.2	17.7	17.9	18.1	18.3	18.8	
	6H	18.0	18.2	18.5	18.6	19.1	17.6	17.7	18.1	18.2	18.7	
	12H	18.1	18.4	18.6	18.8	19.2	17.7	18.0	18.1	18.4	18.8	
Variation of the observer position for the luminaire distances S:												
S = 1.0H		+3.8 / -12.2					+4.7 / -13.4					
S = 1.5H		+6.5 / -14.3					+7.5 / -14.8					
S = 2.0H		+8.5 / -15.6					+9.5 / -15.5					
Standard table		BK00					BK00					
Correction		0.0					-0.4					
Summand		0.0					-0.4					
Corrected Glare Indices referring to 3283lm Total Luminous Flux												

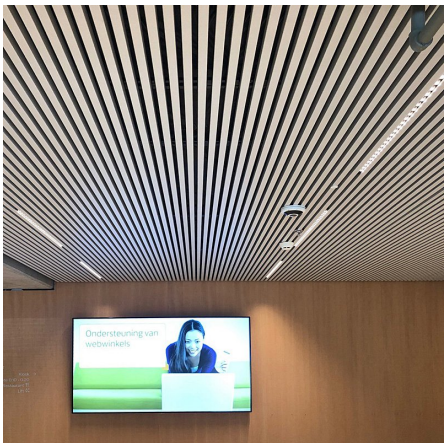
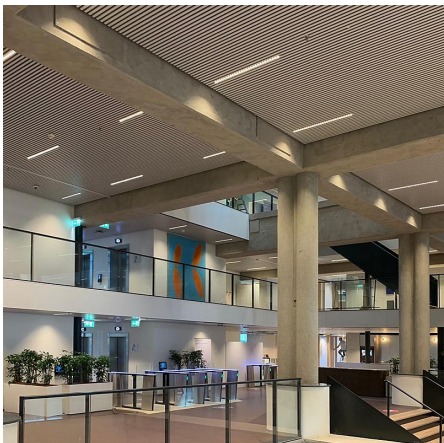
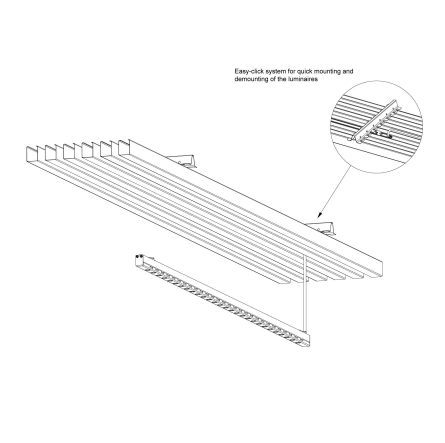

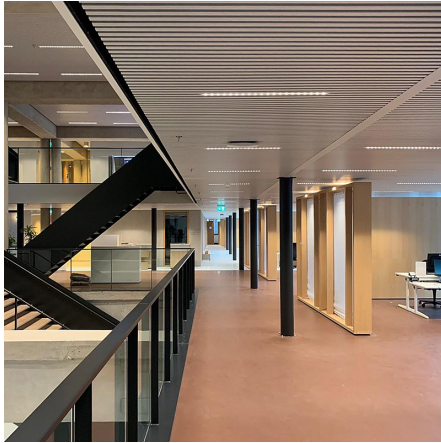

A linear lighting fixture with lenses for use in Interalu SAPP® ceilings.

- Sirio SAPP 1500 can be placed between structures, creating an integrated system with the ceiling without disrupting the architectural appearance.
- Provides highly controlled light distribution, excellent uniformity and UGR<19
- The fixture complies with NEN-EN 12464-1

Downloads

[Photometrics Sirio SAPP](#)

Create your own product, download the PDF specification sheet or add to the quotation:

NOTES

ADDITIONAL INFORMATION

Driver position	Loose driver
Application	Education, Hospitality, Office, Public spaces
Shape	Rectangular
Energy Rating	
Product Glare (UGR)	
Color temperature	Tunable White, 2700K
Voltage / frequency	
Expected lifespan	L90B50@60,000h (Tq 25°C)
Color Rendering Index (CRI)	CRI80, CRI90
Lighting control	1-10V dimming, Casambi dimming, DALI dimming, Optional
Emergency lighting	1 hour emergency power, Optional, Optional 1 hour autonomy self-test
Primary connections	GST18i3, GST18i5 pastelblauw, Kabel, On the driver
Product Color	On request, RAL9010 mat, RAL9010 mat structuur, RAL9011 mat, RAL9011 mat structuur, RAL9016 mat, RAL9016 mat structuur
Optics	Lens en louver
Self-adhesive dust cover	No
Spot bundle (FWHM)	
Luminaire efficacy	>130lm/W
Air extraction	N/A
Product family	Sirio
Product Confirmation	Recessed
Ambient temperature	-20°C / +40°C
Oriëntatie	Down
Material	Acrylic, Steel
IP Rating	IP20 (upwards)/IP40 (downwards)
Lengte	
Width	
Packaging dimensions	Bulk packaging
CIE Flux code	94 100 100 100 100
Power factor	>0.9

Insulation Class	Class II
Kleurconsistentie (SDCM)	SDCM=3
Photobiological safety	IEC 62471: RG1 (low risc)
Specifications	G7D1 / 06-02-2025

