

SIRIO SAPP 600

A linear lighting fixture with lenses for use in Interlu SAPP® ceiling. Sirio SAPP 600 can be placed between the structures, creating an integrated system with the ceiling, without interrupting the architectural appearance.

- Can be placed anywhere in the ceiling between the SAPP® ceiling structures without interrupting the climate circuit
- Provides a highly controlled light distribution, good uniformity and UGR< 19
- The fixture complies with NEN-EN 12464-1

Categories: [Baffle luminaires](#)



PRODUCT IMAGES

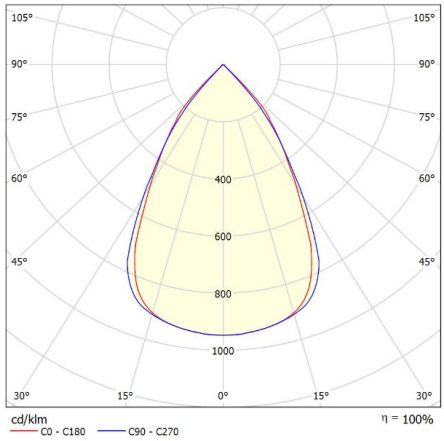
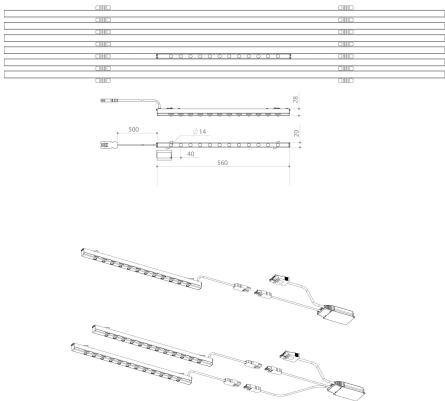
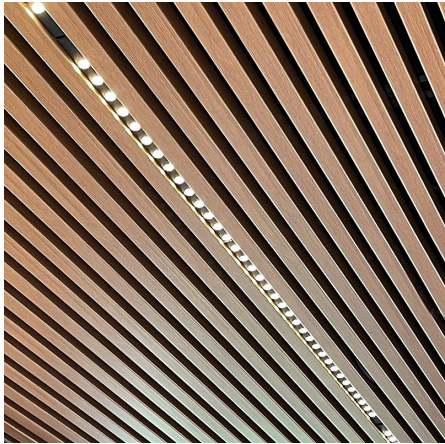

Glare Evaluation According to UGR												
		70	70	50	50	30	70	70	50	50	30	30
p Ceiling		50	30	20	20	20	50	30	20	20	20	20
p Walls		20	20	20	20	20	50	30	20	20	20	20
p Floor		20	20	20	20	20	50	30	20	20	20	20
Room Size X Y		Viewing direction at right angles to lamp axis					Viewing direction parallel to lamp axis					
2H	2H	18.7	19.4	18.9	19.6	19.8	18.3	19.0	18.5	19.2	19.4	19.4
	3H	18.6	19.2	18.8	19.4	19.7	18.1	18.8	18.4	19.0	19.2	19.2
	4H	18.5	19.1	18.8	19.3	19.6	18.1	18.7	18.4	18.9	19.2	19.2
	6H	18.4	19.0	18.7	19.2	19.5	18.0	18.5	18.3	18.6	19.1	19.1
	12H	18.3	18.8	18.7	19.1	19.5	17.9	18.4	18.3	18.7	19.0	19.0
4H	2H	18.5	19.1	18.8	19.3	19.6	18.1	18.7	18.4	18.9	19.2	19.2
	3H	18.3	18.8	18.7	19.1	19.5	17.9	18.4	18.3	18.7	19.0	19.0
	4H	18.3	18.7	18.6	19.0	19.4	17.9	18.3	18.2	18.6	19.0	19.0
	6H	18.2	18.6	18.6	18.9	19.3	17.8	18.1	18.2	18.5	18.9	18.9
	12H	18.1	18.5	18.6	18.9	19.3	17.8	18.1	18.2	18.5	18.9	18.9
8H	2H	18.1	18.4	18.6	18.8	19.2	17.7	18.0	18.2	18.4	18.8	18.8
	3H	18.2	18.5	18.6	18.9	19.3	17.7	18.1	18.2	18.4	18.8	18.8
	4H	18.1	18.3	18.5	18.7	19.2	17.7	17.9	18.1	18.3	18.8	18.8
	6H	18.0	18.2	18.5	18.7	19.2	17.6	17.8	18.1	18.3	18.7	18.7
	12H	18.0	18.2	18.5	18.6	19.1	17.6	17.7	18.1	18.2	18.7	18.7
12H	2H	18.1	18.4	18.6	18.8	19.2	17.7	18.0	18.1	18.4	18.8	18.8
	3H	18.0	18.2	18.5	18.7	19.2	17.6	17.8	18.1	18.3	18.7	18.7
	4H	18.0	18.2	18.5	18.6	19.1	17.6	17.7	18.1	18.2	18.7	18.7
	6H	18.0	18.2	18.5	18.6	19.1	17.6	17.8	18.1	18.3	18.7	18.7
	12H	18.0	18.2	18.5	18.6	19.1	17.6	17.7	18.1	18.2	18.7	18.7
Variation of the observer position for the luminaire distances S:												
S = 1.0H		+3.8 / -12.2					+4.7 / -13.4					
S = 1.5H		+6.5 / -14.3					+7.5 / -14.8					
S = 2.0H		+8.5 / -15.6					+9.5 / -15.5					
Standard table		BK00					BK00					
Correction Summand		0.0					-0.4					
Corrected Glare Indices referring to 3283lm Total Luminous Flux												

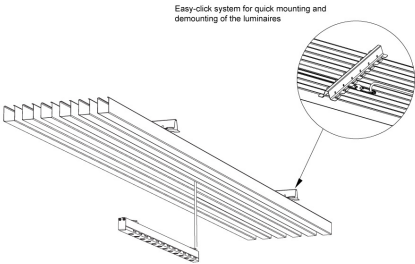
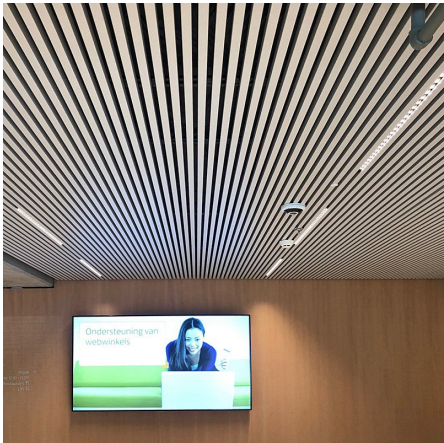
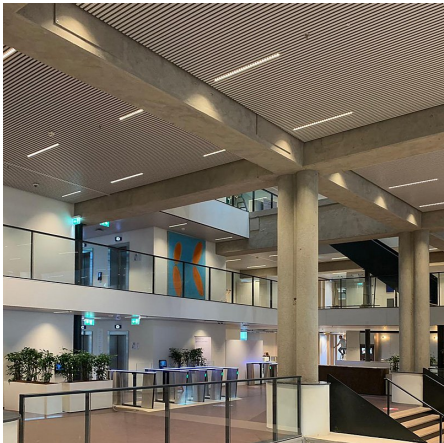

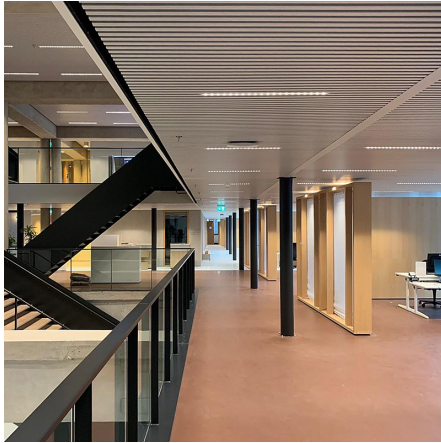

A linear lighting fixture with lenses for use in Interalu SAPP® ceiling. Sirio SAPP 600 can be placed between the structures, creating an integrated system with the ceiling, without interrupting the architectural appearance.

- Can be placed anywhere in the ceiling between the SAPP® ceiling structures without interrupting the climate circuit
- Provides a highly controlled light distribution, good uniformity and UGR < 19
- The fixture complies with NEN-EN 12464-1

NOTES

ADDITIONAL INFORMATION

Self-adhesive dust cover	No
Driver position	Loose driver
Application	Education, Hospitality, Office, Public spaces
Shape	Rectangular
Color temperature	2700K
Expected lifespan	L90B50@60,000h (Tq 25°C)
Color Rendering Index (CRI)	CRI80, CRI90
Lighting control	1-10V dimming, Casambi dimming, DALI dimming, Optional
Emergency lighting	1 hour emergency power, Optional, Optional 1 hour autonomy self-test
Primary connections	GST18i3, GST18i5 pastelblauw, Kabel, On the driver
Product Color	On request, RAL9010 mat, RAL9010 mat structuur, RAL9011 mat, RAL9011 mat structuur, RAL9016 mat, RAL9016 mat structuur
Optics	Lens en louver
Luminaire efficacy	>130lm/W
Air extraction	N/A
Product family	Sirio
Product Confirmation	Recessed
Ambient temperature	-20°C / +40°C
Oriëntatie	Down
Material	Acrylic, Steel
IP Rating	IP20 (upwards)/IP40 (downwards)
Packaging dimensions	Bulk packaging
CIE Flux code	93 100 100 100 100
Power factor	>0.9
Insulation Class	Class II
Kleurconsistentie (SDCM)	SDCM=3
Photobiological safety	IEC 62471: RG1 (low risc)

