



FUSION EASY-KLIMAPLUS

Fusion Easy-KlimaPlus, a linear luminaire for use in Interlu Easy-KlimaPlus climate ceilings with a prismatic lens or an opal diffuser. This LED luminaire was developed as an alternative to T5 linear fluorescent luminaires for use in both renovation and new construction projects

- Seamlessly integrates into Interlu Easy-KlimaPlus metal ceilings
- Architectural appearance
- Equipped with a prismatic lens (UGR < 19) or an opal diffuser<

Downloads

[Photometrics Fusion-EKP](#)

Create your own custom made product, download the PDF specsheet or add to quote:

Categories: [Climate ceiling fixtures](#)



PRODUCT IMAGES

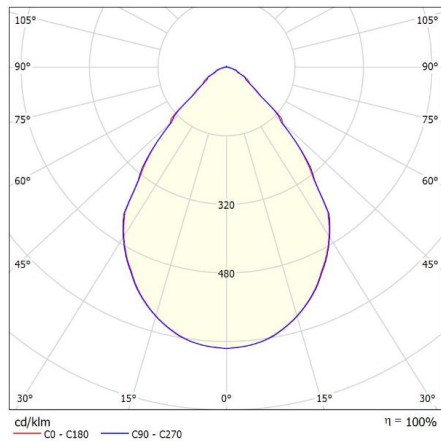
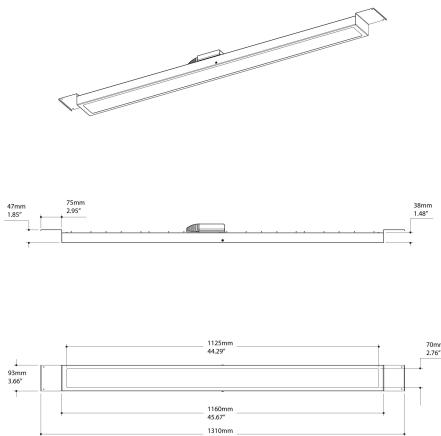

Glare Evaluation According to UGR													
		70	70	50	50	30	30	70	70	50	50	30	
ρ Ceiling		50	30	50	30	50	30	50	30	50	30	30	
ρ Wall		20	20	20	20	20	20	20	20	20	20	20	
ρ Floor		20	20	20	20	20	20	20	20	20	20	20	
Room Size	X	Viewing direction at right angles to lamp axis						Viewing direction parallel to lamp axis					
2H	2H	17.3	18.2	17.6	18.4	18.7	17.2	18.2	17.5	18.4	18.6	18.6	
	4H	17.6	18.4	17.9	18.7	19.0	17.6	18.4	17.9	18.7	18.9	19.0	
	6H	17.8	18.6	18.1	18.9	19.1	17.8	18.6	18.1	18.8	19.1	19.2	
	8H	17.9	18.6	18.2	18.9	19.2	17.9	18.6	18.2	18.9	19.2	19.2	
	12H	18.0	18.6	18.3	18.9	19.3	17.9	18.6	18.3	18.9	19.2	19.2	
4H	2H	17.3	18.1	17.6	18.4	18.7	17.3	18.1	17.6	18.3	18.6	18.6	
	3H	17.8	18.4	18.2	18.8	19.1	17.8	18.4	18.1	18.8	19.1	19.1	
	4H	18.1	18.6	18.5	19.0	19.4	18.1	18.6	18.5	19.0	19.4	19.4	
	6H	18.3	18.8	18.7	19.1	19.5	18.3	18.7	18.7	19.1	19.5	19.5	
	8H	18.3	18.8	18.8	19.2	19.6	18.3	18.7	18.7	19.1	19.6	19.6	
8H	4H	18.1	18.6	18.6	19.0	19.4	18.3	18.7	18.8	19.2	19.6	19.6	
	6H	18.4	18.7	18.8	19.2	19.6	18.4	18.7	18.8	19.1	19.6	19.6	
	8H	18.5	18.8	18.9	19.2	19.7	18.4	18.7	18.9	19.2	19.7	19.7	
	12H	18.6	18.8	19.1	19.3	19.8	18.5	18.8	19.0	19.2	19.8	19.8	
	12H	18.4	18.5	18.8	19.1	19.6	18.3	18.6	18.8	19.1	19.6	19.6	
8H	8H	18.5	18.7	18.8	19.2	19.7	18.4	18.7	18.9	19.2	19.7	19.7	

Variation of the observer position for the luminance distances 5

S = 1.0H	+1.2 / -1.7	+1.1 / -1.6
S = 1.5H	+2.3 / -2.1	+2.4 / -1.9
S = 2.0H	+3.8 / -2.8	+3.9 / -2.9

Standard table

BK02	BK02
Correction	0.4
Summed	0.4

Corrected Glare indices referring to 360/20 mm Total Luminous Flux

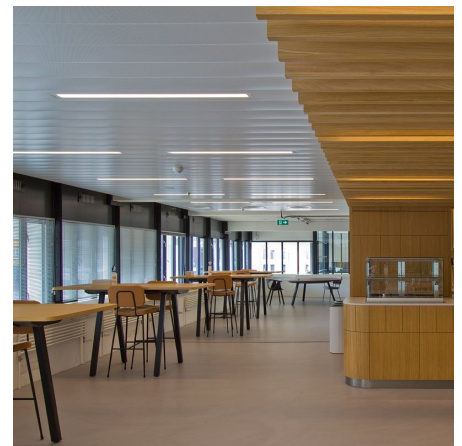
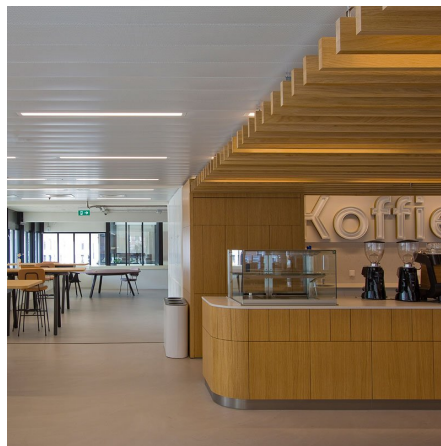
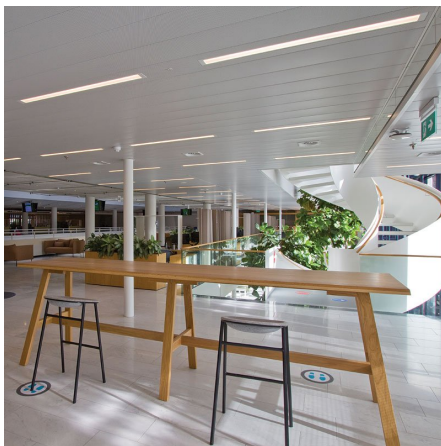

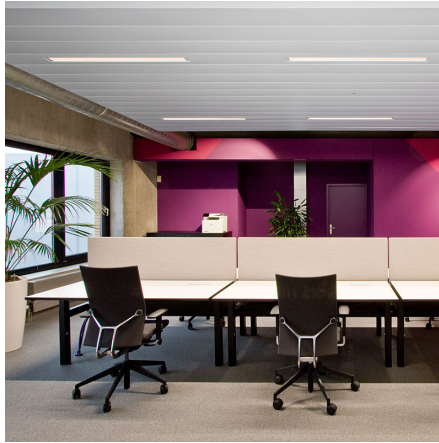

Fusion Easy-KlimaPlus, a linear luminaire for use in Interalu Easy-KlimaPlus climate ceilings with a prismatic lens or an opal diffuser. This LED luminaire was developed as an alternative to T5 linear fluorescent luminaires for use in both renovation and new construction projects

- Seamlessly integrates into Interalu Easy-KlimaPlus metal ceilings
- Architectural appearance
- Equipped with a prismatic lens (UGR < 19) or an opal diffuser<

Downloads

[Photometrics Fusion-EKP](#)

Create your own custom made product, download the PDF specsheet or add to quote:

NOTES

ADDITIONAL INFORMATION

Kleurtemperatuur	Tunable White, 2700K
Driver positie	Loose driver
Kleurconsistentie (SDCM)	SDCM=3
Ambient temperature	-20°C / +40°C
Productkleur	On request
Photobiological safety	IEC 62471: RG1 (low risc)
Light control	1-10V dimming, Casambi dimming, DALI dimming
Emergency lighting	1 hour emergency power, Optional, Optional 1 hour autonomy self-test
Primaire aansluitingen	BST 14i2, Europlug, On request, GST18i3, GST18i5 pastelblauw, On the driver
Producttoepassing	Education, Hospitality, Office, Public spaces
Material	Acrylic, Aluminium, Steel
Family	Fusion
Armaturefficiëntie	>140lm/W
Isolatieklasse	Class II
Optics	Microprismatic lens, Opalen diffusor
Oriëntatie	Down
Shape	Rectangular
Bevestiging	Recessed

