



MESON PRO 190-C

Meson Pro 190-C is a series of high-quality LED downlights for surface mounting, equipped with a glare-reducing reflector and a satin diffuser. The innovative design of LED array, light chamber, reflector and diffuser forms an optical system with high system efficiency and excellent visual comfort. Meson pro 190-C has a highly effective Light Output Ratio (LOR) more than 84% and an Unified Glare Rating (UGR) between <16 and <19 depending on the luminaire flux which makes the downlighter EN 1.2464/1 compliant for office applications.

- Housing in matte white or matte black
- UGR< 17 to UGR< 19 depending on luminous flux
- Emergency lighting versions available

Downloads

[Photometrics Meson Pro 190-C](#) [Download Meson Pro BIM files](#)

Categories: [Surface-mounted luminaires](#)



PRODUCT IMAGES

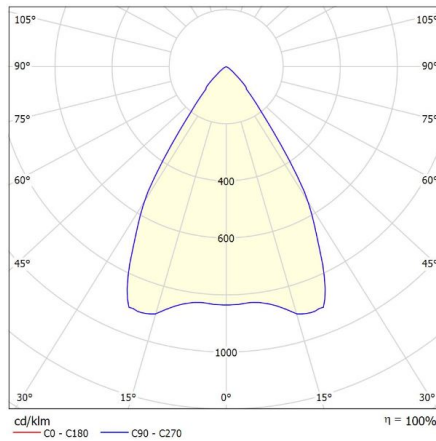
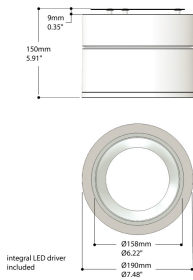

Glare Evaluation According to UGR												
p. Ceiling	70	70	50	50	30	70	70	50	50	30		
p. Walls	50	30	50	30	30	50	30	50	30	30		
p. Floor	20	20	20	20	20	20	20	20	20	20		
Room Size	Viewing direction at right angles to lamp axis					Viewing direction parallel to lamp axis						
X	Y											
2H	2H	19.0	19.7	19.2	19.9	20.1	19.0	19.7	19.2	19.9	20.1	
	3H	18.8	19.5	19.1	19.7	19.9	18.8	19.5	19.1	19.7	19.9	
	4H	18.8	19.4	19.1	19.6	19.9	18.8	19.4	19.1	19.6	19.9	
	6H	18.7	19.2	19.0	19.5	19.8	18.7	19.2	19.0	19.5	19.8	
	12H	18.6	19.2	19.0	19.5	19.8	18.6	19.2	19.0	19.5	19.8	
4H	2H	18.8	19.4	19.1	19.6	19.9	18.8	19.4	19.1	19.6	19.9	
	3H	18.6	19.1	19.0	19.4	19.8	18.6	19.1	19.0	19.4	19.8	
	4H	18.6	19.0	18.9	19.3	19.7	18.6	19.0	18.9	19.3	19.7	
	6H	18.5	18.9	18.9	19.2	19.6	18.5	18.9	18.9	19.2	19.6	
	12H	18.4	18.7	18.8	19.1	19.5	18.4	18.7	18.8	19.1	19.5	
6H	2H	18.5	18.8	18.9	19.2	19.6	18.5	18.8	18.9	19.2	19.6	
	3H	18.4	18.6	18.8	19.0	19.5	18.4	18.6	18.8	19.0	19.5	
	4H	18.3	18.5	18.8	19.0	19.4	18.3	18.5	18.8	19.0	19.4	
	6H	18.3	18.4	18.8	18.9	19.4	18.3	18.4	18.8	18.9	19.4	
	12H	18.3	18.4	18.8	18.9	19.4	18.3	18.4	18.8	18.9	19.4	
Variation of the observer position for the luminance distances S												
S = 1.0H		+5.0 / -8.2						+5.0 / -8.2				
S = 1.5H		+7.7 / -13.2						+7.7 / -13.2				
S = 2.0H		+9.7 / -13.2						+9.7 / -13.2				
Standard table		BK00					BK00					
Correction		0.3					0.3					
Corrected Glare indices referring to 2683lm Total Luminous Flux												

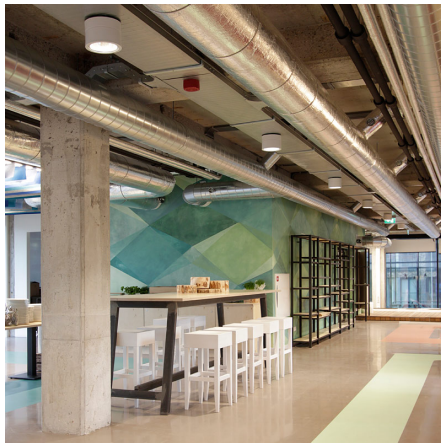

Meson Pro 190-C is a series of high-quality LED downlights for surface mounting, equipped with a glare-reducing reflector and a satin diffuser. The innovative design of LED array, light chamber, reflector and diffuser forms an optical system with high system efficiency and excellent visual comfort. Meson pro 190-C has a highly effective Light Output Ratio (LOR) more than 84% and an Unified Glare Rating (UGR) between <16 and <19 depending on the luminaire flux which makes the downlighter EN 1.2464/1 compliant for office applications.

- Housing in matte white or matte black
- UGR< 17 to UGR< 19 depending on luminous flux

- Emergency lighting versions available

Downloads

[Photometrics Meson Pro 190-C](#) [Download Meson Pro BIM files](#)

NOTES

ADDITIONAL INFORMATION

Kleurtemperatuur	Tunable White, 2700K
Ambient temperature	-20°C / +40°C
Productkleur	On request
Light control	1-10V dimming, Casambi dimming, DALI dimming
Emergency lighting	1 hour emergency power, Optional, Optional 1 hour autonomy self-test
Producttoepassing	Education, Hospitality, Office, Public spaces
Primaire aansluitingen	On the driver
Driver positie	Integrated
Isolatieklasse	Class II
Family	Meson
Energielabel	A++
Kleurconsistentie (SDCM)	SDCM=2
Voltage / frequency	220-240V, 50 / 60Hz
Powerfactor	>0.9
Material	Acrylic, Steel
Oriëntatie	Down
Bevestiging	Ceiling mounting
Shape	Round
Photobiological safety	IEC 62471: RG1 (low risc)

